

CONTRACT DOCUMENTS FOR TENANT IMPROVEMENT:

TACO BRO'S

AT CDNK RETAIL OFFICE BUILDING

1467 SW GATLIN BLVD, PORT ST. LUCIE, FLORIDA 34953

08/29/2023
T-23100

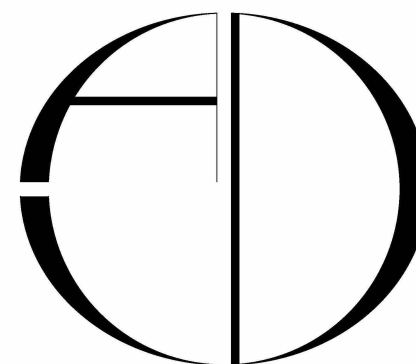

ARCHITECTS DESIGN
COLLABORATIVE, LLC
ARCHITECTURE | URBAN DESIGN
PLANNING | INTERIORS
10489 SOUTHWEST MEETING ST
TRADITIONAL
PORT ST. LUCIE, FL 34987
TEL: (772) 286-9004

AFF	ABOVE FINISHED FLOOR	DIA	DIAMETER	GFRG	GLASS FIBER REINFORCED	ORD	OVERFLOW ROOF DRAIN	SS	SQUARE FEET/FOOT
AFG	ABOVE FINISHED GRADE	DIFF	DIFFUSER	GLAZ	GYPJUM	OH	OVERHEAD	SS	STAINLESS STEEL
ACC	ACCESSIBLE	DIM	DIMENSION	GLAZ	GLAZING	OFCl	OWNER FURNISHED	SP	STANDPIPE
ACT	ACOUSTIC CEILING TILE	DIMS	DIMENSIONS	GB	GRAB BAR	OFOI	OWNER FURNISHED, OWNER INSTALLED	STA	STATION
ACOUS	ACOUSTICAL	DW	DISHWASHER	GRAN	GRANULAR			STL	STEEL
T		DISP	DISPENSER	GRD	GROUND			STOR	STORAGE
APC	ACOUSTICAL PANEL CEILING	DIV	DIVISION	GYP	GYPJUM	P	PAINT	SD	STORM DRAIN
ADJ	ADJACENT	DO	DOOR	GWB	GYPJUM WALL BOARD	PNT	PAINT OR PAINTED	STRG	STRINGER
AGGR	AGGREGATE	DR	DOOR OPENING	HC	HANDICAPPED	PTD	PAINTED	STRUC	STRUCTURAL
AC	AIR CONDITIONING	DBL	DOUBLE	HNDRL	HANDRAIL	PR	PAIR	T	STRUCTURE OR STRUCTURAL
ALT	ALTERNATE	DN	DOWN	HDWR	HARDWARE	PNL	PANEL	STRUC	STRUCTURE OR STRUCTURAL
ALUM	ALUMINUM	DS	DOWNSPOUT	HDWD	HARDWOOD	PBD	PARTICLE BOARD	T	SUBCA
AB	ANCHOR BOLT	DRN	DRAIN	HTG	HEATING	PTN	PARTITION	T	SUBCATEGORY
&	AND	DWR	DRAWER	HVAC	HEATING VENTILATION & AIR CONDITIONING	PAV	PAVING	SA	SUPPLY AIR
ANOD	ANODIZED	DWG	DRAWING	HGT	HEIGHT	PERF	PERFORATED	SM	SURFACE MOUNTED
APPRO	APPROXIMATE	DF	DRINKING FOUNTAIN	H	HIGH/HEIGHT	PERP	PERPENDICULAR	SUSP	SUSPENDED
X		EA	EACH	HO	HOLD OPEN	PLAS	PLASTER	SYM	SYMMETRICAL
ARCH	ARCHITECTURAL	E	EAST	HM	HOLLOW METAL	PLAM	PLASTIC LAMINATE	SYS	SYSTEM
AD	AREA DRAIN	ELEC	ELECTRICAL	HORIZ	HORIZONTAL	PL	PLATE	TKBD	TACK BOARD
ASPH	ASPHALT	EP	ELECTRICAL PANEL	HB	HOSE BIB	PLBG	PLUMBING	TEL	TELEPHONE
@		EL	ELEVATION	HB	HOSE BIBB	PLYWD	PLYWOOD	TEL	TELEPHONE/TELECOM
ATTN	ATTENTION	ELEV	ELEVATOR	HRC	HOSE REEL CABINET	PT	POINT	TV	TELEVISION
AV	AUDIOVISUAL	EMER	EMERGENCY	HW	HOT WATER	POL	POLISHED	TEMP	TEMPERATURE
AUTO	AUTOMATIC	ENCL	ENCLOSURE	HR	HOUR	PVC	POLYVINYL CHLORIDE	TMPD	TEMPERED
BSMNT	BASEMENT	ENG	ENGINEER	INCAN	INCANDESCENT	PLF	POUNDS PER LINEAR FOOT	TEMP	TEMPORARY
BM	BEAM	EQ	EQUAL	IN	INCH/INCHES	PSF	POUNDS PER SQUARE FOOT	THK	THICKNESS
BRG	BEARING	EQUIP	EQUIPMENT	INCL	INCLUDED/INCLUDING	PDF	POWER DRIVEN FASTENER	THRU	THROUGH
BIT	BITUMINOUS	EPDM	ETHYLENE PROPYLENE DIENE M-CLASS	INFO	INFORMATION	PC	PREFABRICATED	TLT	TOILET
BLK	BLOCK			ID	INSIDE DIAMETER	PREFAB		T&G	TONGUE AND GROOVE
BLKG	BLOCKING	EXH	EXHAUST	INSUL	INSULATED OR INSULATION	B	PRESSURE TREATED	TO	TOP
BD	BOARD	EXIST	EXISTING	INSUL	INSULATION	PROJ	PROJECT	TOB	TOP OF BEAM
BOT	BOTTOM	EXP	EXPANSION	INT	INTERIOR	QTY	QUANTITY	TOC	TOP OF CONCRETE
BO	BOTTOM OF	EB	EXPANSION BOLT	INTER	INTERMEDIATE	QT	QUARRY TILE	TOS	TOP OF STEEL
BRKT	BRACKET	EJ	EXPANSION JOINT	INVERT	INVERT	R	RADIUS	TB	TOWEL BAR
BRK	BRICK	EXT	EXTERIOR	INV	INVERT	RWL	RADIUS/RISER	T	TREAD
BLDG	BUILDING	FWC	FABRIC WALL COVERING	JAN	JANITOR	RTD	RATED	TS	TUBE STEEL
CAB	CABINET	FWP	FABRIC WRAPPED PANEL	JC	JANITOR'S CLOSET	RTG	RATING	TYP	TYPICAL
CPT	CARPET	FB	FACE BRICK	JT	JOINT	RECPT	RECEPTACLE	UNFIN	UNFINISHED
CI	CAST IRON	FO	FACE OF	JST	JOIST	REC	RECESSED	UNO	UNLESS NOTED OTHERWISE
CIP	CAST-IN-PLACE	FT	FEET/FOOT	KIT	KITCHEN	REF	REFERENCE	UON	UNLESS OTHERWISE NOTED
CB	CATCH BASIN	FRC	FIBER REINFORCED CONCRETE	KO	KNOCK OUT	RCP	REFLECTED CEILING PLAN	URNL	URNAL
CAT	CATEGORY	FIN	FINISH	LAM	LAMINATE	REFR	REFRIGERATOR	VAR	VAPOR RETARDER
CLG	CEILING	FFEL	FINISH FLOOR ELEVATION	LAV	LAVATORY	REG	REGISTER	VAR	VARIES
CEM	CEMENT	FA	FIRE ALARM	LT	LIGHT	REIN	REINFORCED	VAC	VENTILATION AND AIR CONDITIONING
CBU	CEMENTITIOUS BACKER UNIT	FDC	FIRE DEPARTMENT CONNECTION	LLH	LONG LEG HORIZONTAL	REIN	REINFORCED	VIF	VERIFY IN FIELD
CTR	CENTER	FE	FIRE EXTINGUISHER	LLV	LONG LEG VERTICAL	REL	RELOCATE	VERT	VERTICAL
CC	CENTER TO CENTER	FEC	FIRE EXTINGUISHER CABINET	LB	POUNDS	REM	REMOVABLE	VEST	VESTIBULE
CL	CENTERLINE	FHC	FIRE HOSE CABINET	MH	MANHOLE	REQ	REQUIRE/REQUIRED	VCT	VINYL COMPOSITION TILE
CER	CERAMIC	FP	FIRE PROTECTION	MFR	MANUFACTURER	REQD	REQUIRED	VT	VINYL TILE
CT	CERAMIC TILE	FR	FIRE RESISTANT	MAS	MASONRY	RESIL	RESILIENT	VWC	VINYL WALL COVERING
C	CHANNEL	FRT	FIRE RETARDANT TREATED	MO	MASONRY OPENING	RB	RESILIENT BASE	VP	VISION PANEL
CH	CHILLER	FPG	FIREPROOFING	MAX	MAXIMUM	RA	RETURN AIR	WSCT	WAINSCOT
CO	CLEANOUT	FIXT	FIXTURE	MECH	MECHANICAL	REV	REVISION/REVISED	WC	WATER CLOSET
CLR	CLEAR	FLASH	FLASHING	MED	MEDIUM	RD	ROOF DRAIN	WV	WATER VALVE
CCTV	CLOSED CIRCUIT TELEVISION	FLH	FLAT HEAD	MEMBR	MEMBRANE	RM	ROOM	WPM	WATERPROOF MEMBRANE
CW	COLD WATER	FLR	FLOOR	MTL	METAL	RO	ROUGH OPENING	WP	WATERPROOF/WATERPROOFING
COL	COLUMN	FD	FLOOR DRAIN	MIN	MINIMUM	RBR	RUBBER	WS	WEATHER-STRIPPING
CONC	CONCRETE	FD	FLOOR DRAIN OR FIRE DEPARTMENT	MISC	MISCELLANEOUS	SCHED	SCHEDULE	WT	WEIGHT
CMU	CONCRETE MASONRY UNIT	FLUOR	FLUORESCENT	MR	MOISTURE RESISTANT	SECT	SECTION	WWF	WELDED WIRE FABRIC
COND	CONDITION	MTD	MOUNTED	MTO	MOUNTING	SAF	SELF ADHERED FLASHING	WWM	WELDED WIRE MESH
CONN	CONNECTION	FFB	FLUSH FLOOR BOX	MTG	MOUNTING	SSK	SERVICE SINK	W	WIDE/WEST
CONST	CONSTRUCTION	FTG	FOOTING	MULL	MULLION	SHT	SHEET	WIN	WINDOW
CONT	CONTINUOUS	FND	FOUNDATION	NC	NOISE CRITERIA	SHR	SHOWER	WM	WIRE MESH
CONTR	CONTRACTOR	FURN	FURNITURE	NOM	NOMINAL	SIM	SIMILAR	W/	WITH
CJ	CONTROL JOINT	FF&E	FURNITURE, FIXTURES AND EQUIPMENT	N	NORTH	SC	SOLID CORE	W/O	WITHOUT
COORD	COORDINATE	FURR	FURRING	NA	NOT APPLICABLE	STC	SOUND TRANSMISSION COEFFICIENT	WD	WOOD
CG	CORNER GUARD	GALV	GALVANIZED	NIC	NOT IN CONTRACT	S	SOUTH	SPKR	SPEAKER
CORR	CORRIDOR	GSM	GALVANIZED SHEET METAL	NTS	NOT TO SCALE	OFF	OFFICE	SPEC	SPECIFICATION
CNTR	COUNTER	GA	GAS VALVE	NO	NUMBER	OC	ON CENTER	SPEC	SPECIFIED OR SPECIFICATION
CTS	COUNTERSUNK	GEN	GENERAL	OPNG	OPENING	OA	OUTSIDE AIR	SH	SHRINKER OR SPEAKER
DMPF	DAMP PROOFING	GC	GENERAL CONTRACT(OR)	GL	GLASS	OD	OUTSIDE DIAMETER	SQ	SQUARE
D	DEEP, DEPTH	GL	GLASS	GFRG	GLASS FIBER REINFORCED CONCRETE	OD	OUTSIDE DIAMETER		
DEG	DEGREE	DTL	DETAIL			OD	OVERFLOW DRAIN		
DEMO	DEMOLISH OR DEMOLITION								
DEMO	DEMOLITION								
DEPT	DEPARTMENT								
DTL	DETAIL								

STANDARD SYMBOLS			
101	ROOM SPACE NUMBER		DIRECTION OF SLOPE
ABC...	NOTES		BREAK LINE
	WALL TYPE		REVISION MARK REVISION NUMBER
AF	WINDOW LETTER		AREA TO BE DEMOLISHED
1F	STOREFRONT NUMBER/LETTER		FLOOR PLAN ELEVATION NOTE
101	DOOR TAG		REFLECTED CEILING PLAN ELEVATION NOTE
	INTERIOR ELEVATION WALL (SHADE PORTIONS - SIDE CONSIDERED)		ELEVATION LEVEL LEVEL LINE/CONTROL POINT
	DETAIL		NEW OR EQUIPPED POINT ELEVATION (PLAN)
	BUILDING SECTION		EXISTING POINT ELEVATION (PLAN)
	ELEVATION CHANGE IN SURFACE ELEVATION		TEST BORING
	FLUSH OR CONTINUOUS SURFACE		

PROJECT NARRATIVE:

THESE CONSTRUCTION DOCUMENTS ARE INTENDED FOR THE INTERIOR TENANT IMPROVEMENT OF 1,181 +/- SF TENANT SPACE LOCATED AT 1467 SW GATLIN BLVD, PORT ST. LUCIE, FLORIDA 34953
INTERIOR TENANT IMPROVEMENT INCLUDES:
NEW PARTITIONS, HVAC SYSTEMS, ELECTRICAL SYSTEMS, PLUMBING SYSTEMS, LIGHT FIXTURES, FLOORING, INTERIOR DOORS & PAINT.

INTENT OF CONTRACT DOCUMENT:

IT IS THE INTENT OF THESE DRAWINGS, SPECIFICATIONS AND OTHER DOCUMENTS TO DESCRIBE ALL LABOR MATERIALS AND EQUIPMENT REQUIRED TO COMPLETE THE WORK CALLED FOR, INDICATED OR REASONABLY IMPLIED BY THEM. INCLUDING: ELECTRICAL, PLUMBING, AIR CONDITIONING, SITE WORK AND SUBSURFACE PREPARATIONS AND ALL OTHER ITEMS INCIDENTAL THERETO OR OTHERWISE DESCRIBED.

APPLICABLE CODES:

THE CODES LISTED HEREIN APPLY TO THE WORK TO BE PERFORMED IN ASSOCIATION W/ THESE CONTRACT DOCUMENTS. OMISSION OF A CODE REFERENCE SHALL NOT RELIEVE CONTRACTOR OF COMPLIANCE W/ ALL CODES THAT APPLY TO THE WORK INDICATED OF INFERRED BY THESE DOCUMENTS.

2020 FLORIDA BUILDING CODE 7TH EDITION
2020 FLORIDA FIRE PREVENTION CODE 7TH EDITION
2020 NEC (NFPA, 70) NATIONAL ELECTRICAL CODE
2020 FLORIDA PLUMBING CODE
2020 FLORIDA MECHANICAL CODE
2020 FLORIDA ACCESSIBILITY CODE
2020 EXISTING BUILDING CODE
2020 NFPA, 72

2020 7TH EDITION FBC CODE REVIEW		
	REQUIREMENTS OR ALLOWABLE	PROVIDED
BUILDING DESIGN		ENCLOSED
OCCUPANCY	(SEC. 303.1.1 FBC) 'B' (BUSINESS)	'B' (<50 OCC.)
GENERAL BUILDING LIMITATIONS	TABLE 504.3: ALLOWABLE BUILDING HEIGHT IN FEET ABOVE GRADE PLANE: 55 FT (TYPE II B SPRINKLERED BUILDING)	MEAN HEIGHT: 25'-3" EXISTING
	TABLE 504.4 ALLOWABLE NUMBER OF STORIES ABOVE GRADE PLANE: 4 (S)	STORIES: 1 EXISTING
	TABLE 508.2 ALLOWABLE AREA FACTOR IN S.F. : 92,000 (S1)	TENANT AREA: 1,181 S.F
CONSTRUCTION TYPE	TABLE 601: BUILDING TYPE: II B UNPROTECTED SPRINKLERED	TYPE II B SPRINKLERED ONE STORY REINFORCED CMU LOAD-BEARING EXTERIOR WALLS
STRUCTURAL ELEMENTS	REQ'D	ACTUAL
BEARING WALLS	0	0
NON-BEARING WALLS & PARTITIONS INTERIOR:	0	0
FLOOR CONSTRUCTION (INCLUDE: SUPPORT BEAMS & JOISTS):	0	0
ROOF CONSTRUCTION (INCLUDE: SUPPORT BEAMS & JOISTS):	0	0
FIRE RESISTANT MATERIALS & CONSTRUCTION	CONSTRUCTION SHALL CONFORM TO 2020 7TH EDITION FBC CHAPTER 7	CONSTRUCTION SHALL CONFORM TO 2020 7TH EDITION FBC CHAPTER 7
FIRE PROTECTION SYSTEMS	FIRE SPRINKLERS: NOT REQUIRED	BUILDING WILL BE SPRINKLERED.
MEANS OF EGRESS	TABLE 1017.2 EXIT ACCESS TRAVEL DISTANCE SPRINKLERED B= 300'	44'-0" TRAVEL DISTANCE.
	TABLE 1006.3.2 MINIMUM 2 EXITS REQUIRED	2 EXITS PROVIDED
FBC 2020 EXISTING BUILDING		
LEVEL OF RENOVATION	FBC 2020 EXISTING BUILDING CHAPTER 6 CLASSIFICATION OF WORK	LEVEL 2

NUMBER OF PLUMBING FIXTURES SCHEDULE (FBC TABLE 2902.1)								
OCCUPANCY	TOTAL NUMBER OF OCCUPANT	MEN / WOMEN			DRINKING FOUNTAIN		SERVICE SINK	
		WATER CLOSETS / URINALS		LAVATORY				
		REQ. FIXTURE/ OCC.	MIN. REQ.	REQ. FIXTURE/ OCC.	MIN. REQ.	REQ. FIXTURE/ OCC.	MIN. REQ.	MIN. REQ.
B (BUSINESS)	29	25	1.16	40	0.73	100	NONE*	1
TOTAL REQUIRED:		2		1		NONE		1
PROVIDED:		2		2		NONE		1

NOTE: *(410.4 FBC, PLUMBING) WHERE RESTAURANTS PROVIDE DRINKING WATER IN A CONTAINER FREE OF CHARGE, DRINKING FOUNTAINS SHALL NOT BE REQUIRED IN THOSE RESTAURANTS. REFER TO PLUMBING SCHEDULE FOR PROVIDED PLUMBING FIXTURES

INDEX OF DRAWINGS

SHEET #	DESCRIPTION	CURRENT REV.
A000	COVER SHEET	
A001	GENERAL NOTES AND DATA	
A100	LIFE SAFETY, SLAB REPAIR PLANS & WALL TYPES	
A101	FLOOR PLAN, RCP & DOOR SCHEDULE	
A200	BUILDING SECTIONS & ELEVATIONS	
E0.1	ELECTRICAL NOTES	
E3.1	POWER PLAN	
E4.1	ELECTRICAL NOTES	
E5.1	RISER DIAGRAM	
M0.1	MECHANICAL NOTES	
M2.1	MECHANICAL PLAN	
M6.1	MECHANICAL SCHEDULE	
P0.1	PLUMBING NOTES	
P2.1	SANITARY PLAN	
P3.1	DOMESTIC WATER PLAN	
P4.1	PLUMBING NOTES	
P5.1	SANITARY ISOMETRIC	
TOTAL NUMBER OF SHEETS IN SET: 18		

DEFERRED SUBMITTALS FBC 107.3.4.1

DEFERRED SUBMITTAL DOCUMENTS WILL BE REVIEWED FOR GENERAL CONFORMANCE WITH THE DESIGN INTENT OF THE BUILDING.

GENERAL CONTRACTOR SHALL SUBMIT REVIEW SHOP DRAWINGS SIGNED AND SEALED BY FLORIDA REGISTERED ENGINEER FOR REVIEW AND APPROVAL BY THE ARCHITECT / ENGINEER PRIOR TO FABRICATION.

1. FIRE SPRINKLER PLAN.
2. FIRE ALARM SYSTEM.
3. KITCHEN HOOD.

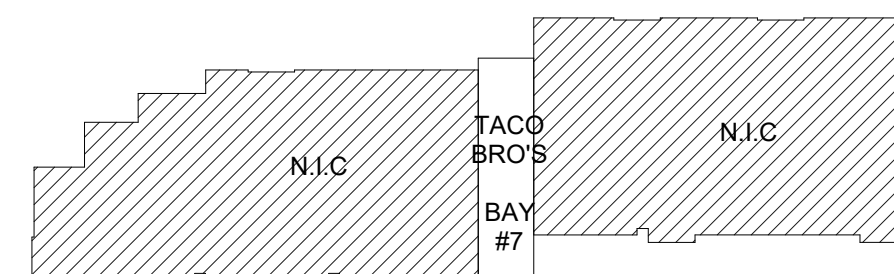



LIFE SATETY PLAN
SCALE: 1/4" = 1'-0"



SLAB REPAIR PLAN

SCALE: 1/4" = 1'-0"

WALL TYPE		FIRE RATING	WALL TYPE		FIRE RATING	WALL TYPE		FIRE RATING
ON EXISTING CMU		NR	INTERIOR		N/A	INTERIOR		N/A
1	1A		2	2A 2B		3		
<p>1 RIGID INSULATION - MIN 3/4 INCH OF RIGID INSULATION (R-5.4)</p> <p>2 FURRING STRIPS - 1 5/8" FURRING AT 24" O.C. MAX 6" ABOVE CEILING GRID.</p> <p>3 GYPSUM WALLBOARD - (1) LAYER OF 5/8" THICK, 4FT WIDE. ATTACHED TO FURRING WITH 1 1/2 INCH LONG TYPES S STEEL SCREW AT 8 INCH O.C. ALONG EDGES OF BOARD AND 12 INCHES O.C. IN THE FIELD OF THE BOARD. JOINTS ORIENTED HORIZONTALLY.</p> <p>EXISTING CMU WALL</p> <p>NOTE: EXISTING CMU WALL</p>			<p>1 FLOOR AND CEILING RUNNERS-CHANNEL SHAPED RUNNERS, 3-5/8 INCH DEEP (MIN), 1-1/4 INCH LEGS, FORMED FROM MIN No 25 MSG GALVANIZED STEEL, ATTACHED TO FLOOR AND DECK WITH FASTENERS SPACED 24 INCHES O.C.</p> <p>2 STEEL STUDS -"C" CHANNEL SHAPED, 3-5/8 INCH DEEP (MIN), FORMED FROM No 25 MSG GALVANIZED STEEL SPACED AT 16 INCH O.C. MAX. STUDS TO BE ATTACHED TO ROOF DECK.</p> <p>3 BATTS AND BLANKETS (OPTIONAL) - MIN 1 INCH OF MINERAL WOOL OR GLASS FIBER BATTS PARTIALLY OR COMPLETELY FILLING STUD CAVITY.FASTEN FOR EACH BATT WITH MIN. 9/16 INCH LONG STAPLES.</p> <p>4 GYPSUM WALLBOARD-(1) LAYER OF 5/8" THICK, 4FT WIDE, ATTACHED TO STEEL STUDS AND FLOORS WITH 1 INCH LONG TYPE S STEEL SCREWS SPACES 8 INCH O.C. ALONG EDGES OF BOARD AND 12 INCHES O.C. IN THE FIELD OF THE BOARD. JOINTS ORIENTED VERTICALLY AND STAGGERED ON OPPOSITE SIDES OF THE ASSEMBLY.</p> <p>5 JOINT AND TAPE COMPOUND-VINYL, DRY OR PREMIXED JOINT COMPOUND, APPLIED IN TWO COATS TO JOINTS AND SCREW HEAD.PAPER TAPE, 2 INCH WIDE, EMBEDDED IN FIRST LAYER OF COMPOUND OVER ALL JOINTS.</p>			<p>1 FLOOR AND CEILING RUNNERS-CHANNEL SHAPED RUNNERS, 3-5/8 INCH DEEP (MIN), 1-1/4 INCH LEGS, FORMED FROM MIN No 20 MSG GALVANIZED STEEL, ATTACHED TO FLOOR AND DECK WITH FASTENERS SPACED 24 INCHES O.C.</p> <p>2 STEEL STUDS -"C" CHANNEL SHAPED, 5-5/8 INCH DEEP (MIN), FORMED FROM No 20 MSG GALVANIZED STEEL SPACED AT 16 INCH O.C. MAX. STUDS TO BE ATTACHED TO STRUCTURE ABOVE.</p> <p>3 BATTS AND BLANKETS (OPTIONAL) - MIN 1 INCH OF MINERAL WOOL OR GLASS FIBER BATTS PARTIALLY OR COMPLETELY FILLING STUD CAVITY.FASTEN FOR EACH BATT</p> <p>4 GYPSUM MOLD TOUGH-(1) LAYER OF 5/8" THICK, 4FT WIDE, ATTACHED TO STEEL STUDS WITH 1 1/2" TYPE S SCREWS @ 8" O.C. ALONG EDGES OF BOARD AND 12" O.C. IN THE FIELD ON ONE SIDE. JOINTS ORIENTED VERTICALLY AND STAGGERED ON OPPOSITE SIDES OF THE ASSEMBLY. TWO SIDES.</p> <p>5 JOINT AND TAPE COMPOUND-VINYL, DRY OR PREMIXED JOINT COMPOUND, APPLIED IN TWO COATS TO JOINTS AND SCREW HEAD.PAPER TAPE, 2 INCH WIDE, EMBEDDED IN FIRST LAYER OF COMPOUND OVER ALL JOINTS.</p> <p>6 FIRE CAULK SEAL TO CONCRETE SLAB BOTH SIDES</p>		
<p>1A WALL TYPE WITH GYPSUM WALL BOARD MOISTURE-RESISTANT ON ONE SIDE.</p>			<p>2A WALL TYPE WITH GYPSUM WALL BOARD MOLD RESISTANT ON ONE SIDE.</p> <p>2B WALL TYPE WITH GYPSUM WALL BOARD MOLD RESISTANT ON TWO SIDES.</p>					

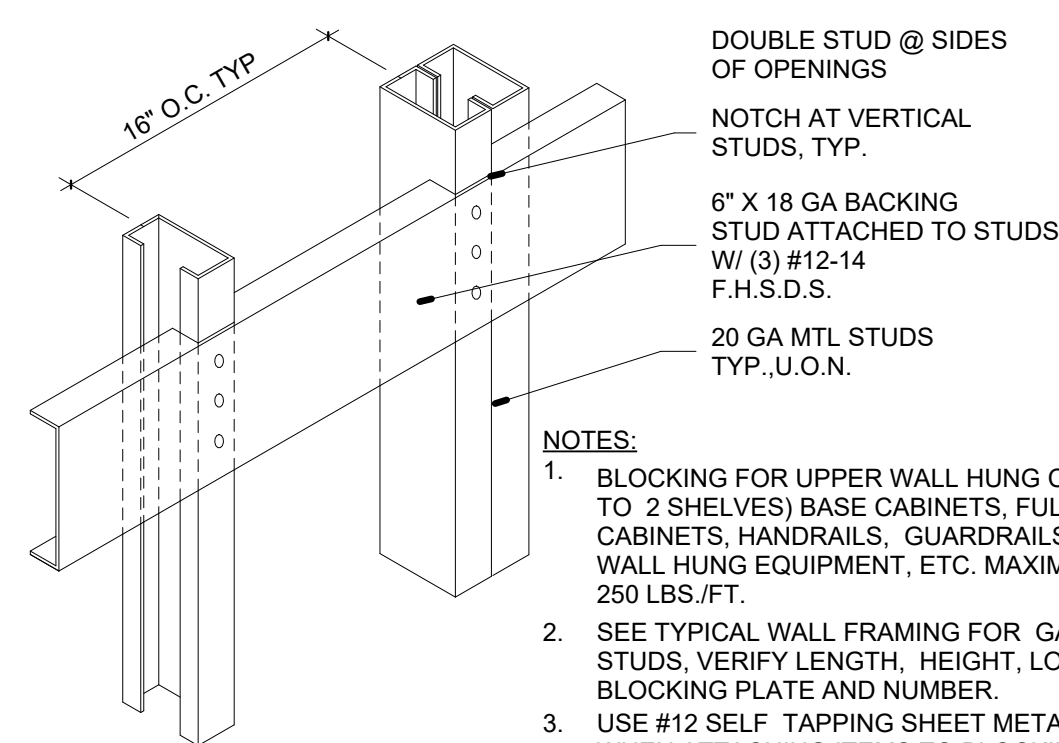

5 GRAB BAR STUD BLOCKING
SCALE: 1" = 1'-0"

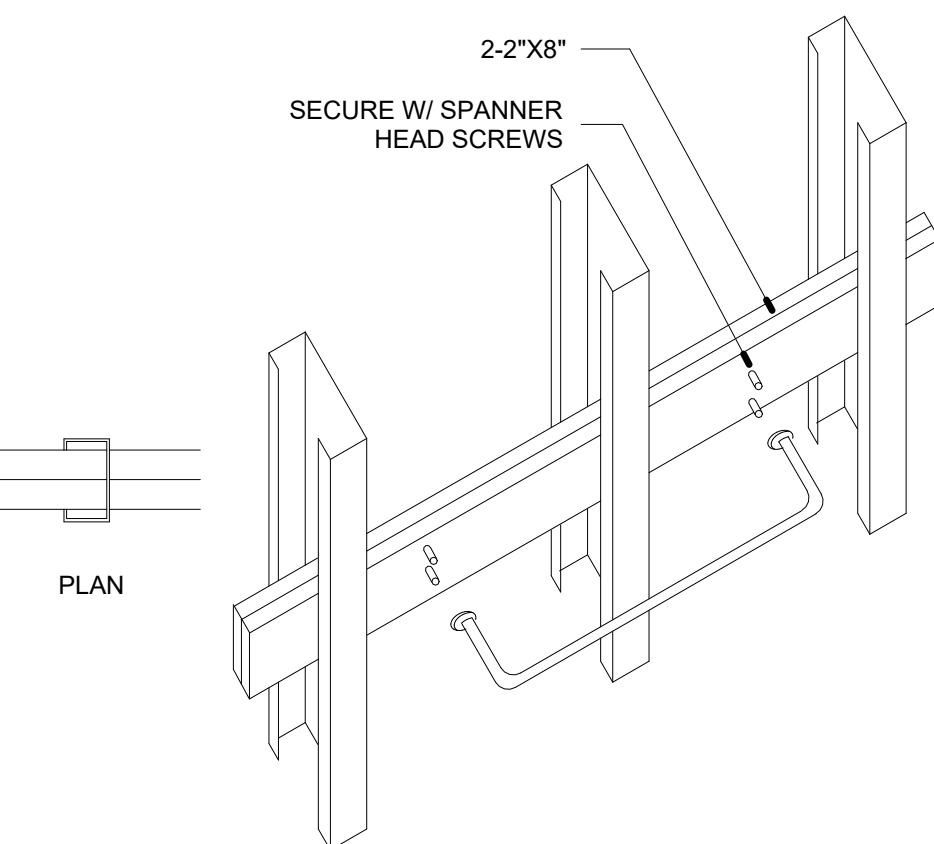

3 GRAB BAR DETAIL
SCALE: 1" = 1'-0"

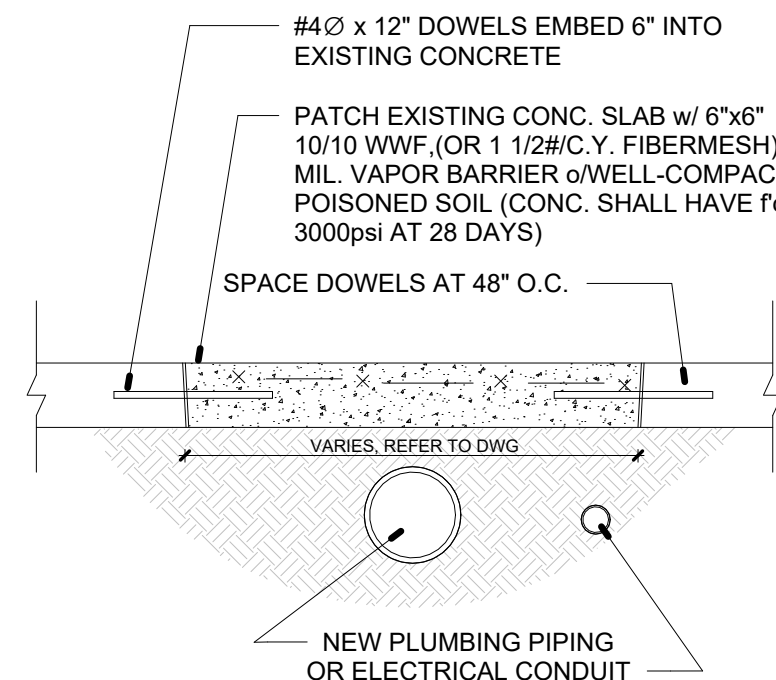

4 SLAB CUT & PATCH DETAIL
SCALE: 1/2" = 1'-0"

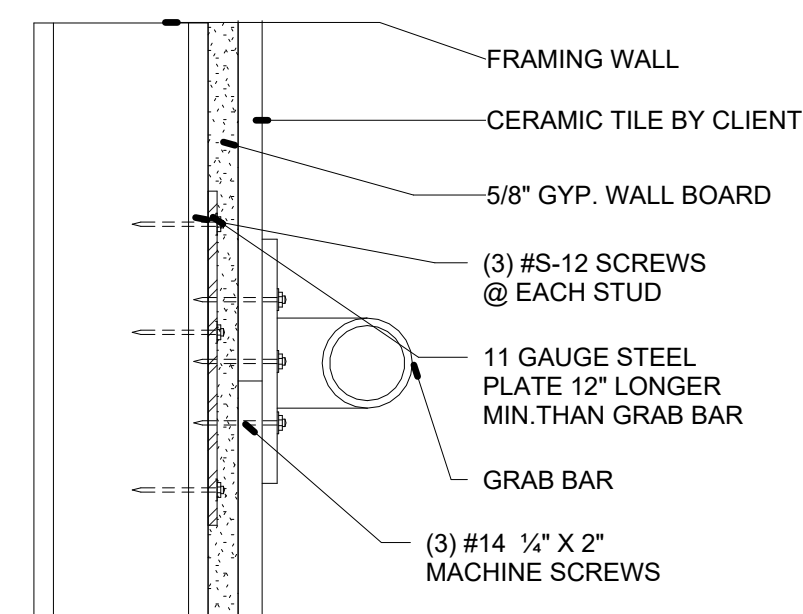

6 GRAB BAR MOUNTING DETAIL
SCALE: 3" = 1'-0"

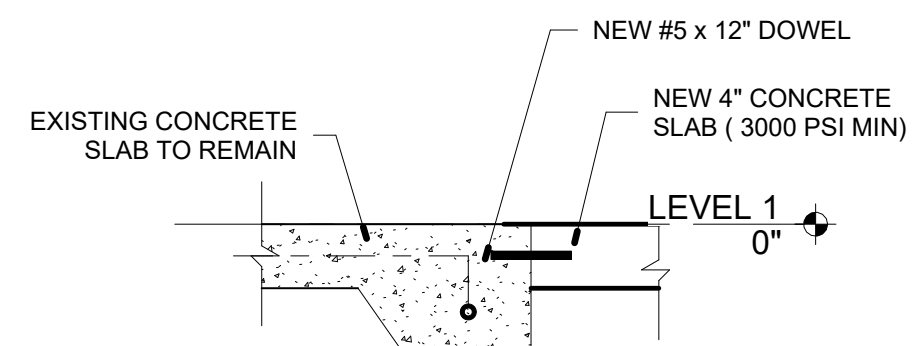

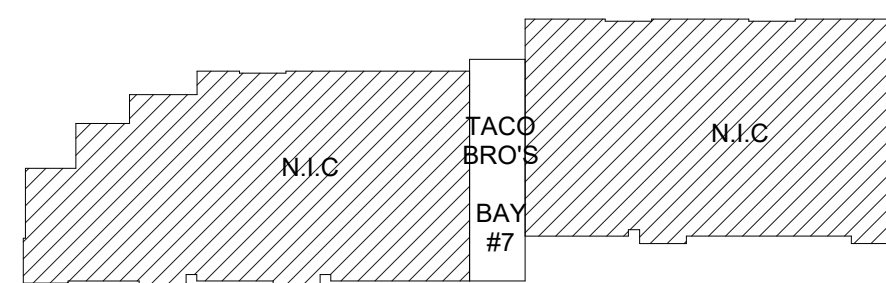

7 SLAB SECTION
SCALE: 1" = 1'-0"



 KEY PLAN

OCCUPANCY TABULATION (F.B.C. TABLE 1004.1.2)							
NAME	AREA	OCC GROUP	FUNCTION SPACE	OCCUPANT LOAD FACTOR	OCCUPANTS	EXIT WIDTH REQUIRED (INCHES)	STAIRS MIN. WIDTH REQUIRED (INCHES)
DRY GOODS	29 SF		ACCESSORY STORAGE AREAS, MECHANICAL EQUIPMENT ROOM	300 GROSS	0.10	0.0	0.0
HALL	64 SF		BUSINESS AREAS	150 GROSS	0.43	0.1	0.1
JANITOR	10 SF		ACCESSORY STORAGE AREAS, MECHANICAL EQUIPMENT ROOM	300 GROSS	0.03	0.0	0.0
KITCHEN	332 SF		BUSINESS AREAS	150 GROSS	2.21	0.4	0.7
POT WASHING	85 SF		BUSINESS AREAS	150 GROSS	0.57	0.1	0.2
REGISTER	85 SF		BUSINESS AREAS	150 GROSS	0.56	0.1	0.2
SEATING AREA	354 SF		ASSEMBLY W/VO FIXED SEATS UNCONCENTRATED (TABLES AND CHAIRS)	15 NET	23.62	4.7	7.1
TOILET 1	56 SF		BUSINESS AREAS	150 GROSS	0.37	0.1	0.1
TOILET 2	49 SF		BUSINESS AREAS	150 GROSS	0.33	0.1	0.1
Grand total: 9	1064 SF				28.23	5.6	8.5

WALL LEGEND	
PLAN	DESCRIPTION
	EXISTING 1HR FIRE RATED TENANT SEPRATION
	NEW FRAMING WALL

FIRE EXTINGUISHER CALCULATION AS PER N.F.P.A.10 6.2.1.1		
NAME	AREA	FIRE EXTINGUISHER REQUIRED
FE	1181 SF	0.4
	1181 SF	0.4

DOOR EGRESS PROVIDED		
MARK	NET DOOR WIDTH	OCCUPANTS
EXD1	68"	340
EXD2	35"	175
	103"	515

FIRE EXTINGUISHER PROVIDED		
MARK	DESCRIPTION	QTY
LEVEL 1		
FE	FIRE EXTINGUISHER	2
		2

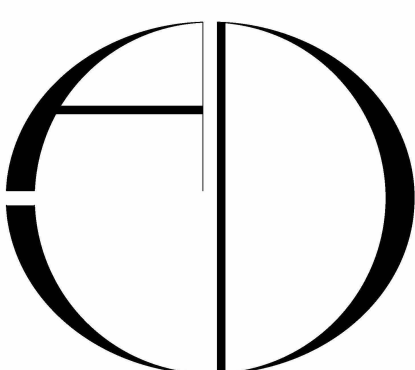

ARCHITECTS DESIGN
COLLABORATIVE, LLC

ARCHITECTURE | URBAN DESIGN
PLANNING | INTERIORS

10489 SOUTHWEST MEETING ST
TRADITION,
PORT ST. LUCIE, FL 34987
TEL. (772) 286 9004

www.ADC-ARCHITECTS.NET

REGISTRATIONS HELD IN THE FOLLOWING STATES:
CALIFORNIA, COLORADO, FLORIDA
GEORGIA, NORTH CAROLINA
MISSISSIPPI, TEXAS

ARCHITECTURE
URBAN DESIGN
PLANNING INTERIORS

THESE DRAWINGS ARE INSTRUMENTS OF SERVICE,
ARCHITECTS DESIGN COLLABORATIVE, LLC HEREBY
PRESERVES ITS COMMON LAW COPYRIGHT AND OTHER
PROPERTY RIGHTS IN THESE PLANS, SPECIFICATIONS,
DESIGNS AND IDEAS. THESE
PLANS, SPECIFICATIONS, DESIGNS AND IDEAS ARE
NOT TO BE COPIED OR REPRODUCED WITHOUT WRITTEN
APPROVAL OF ARCHITECT.

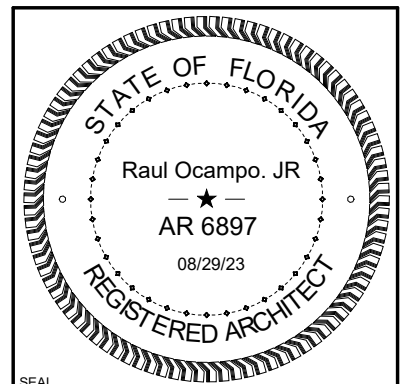

REVISIONS:

[illegible]

CONTRACT DOCUMENTS FOR:
TACO H
AT CDNK RETAIL C
BAY

ADDRESS:
1467 SW GATLIN BLVD, PORT ST. LUCIA

DWG IDENTIFICATION

LIFE SAFETY, SLAB REPAIR PLANS & WALL TYPES

DATE:	08/29/2023
PROJECT PHASE:	CD's
CHECKED / DRAWN BY:	RO/TN
THIS DRAWING HAS BEEN ISSUED ON THE DATE SHOWN & FOR THE PURPOSE NOTED	

JOB FILE NUMBER:
T-23100

A100

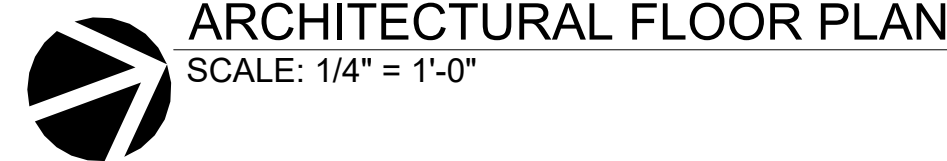

DOOR HARDWARE SCHEDULE					
SET #	MANUFACTURER	STYLE	FINISH	MODEL	STYLE
SET 1	SCHLAGE	PASSAGE	626 SATIN CHROME	ATHENS	ND10S
SET 2	SCHLAGE	PRIVACY LOCK	626 SATIN CHROME	ATHENS	ND40S
SET 3	SCHLAGE	STOREROOM LOCK	626 SATIN CHROME	ATHENS	ND80PD

SPECIALTY EQUIPMENT SCHEDULE			
MARK	TYPE	MFR	MODEL
E1	WALK-IN FREEZER	MANITOWOC	CUSTOM
E2	STEAM TABLE	COOKRITE	CSTE4-3C
E3	WALK-IN COOLER/FREEZER		CUSTOM
E4	GLASS DOOR FRIDGE	KELVINATOR	KCHGM12R
E5	BAR COOLER	ATOSA	SBB48GGRAUS2
G1	FLOOR FRYER	AVANTCO	17FF50N
G2	RANGE - 6 BURNERS	MOTAK	MR6-C-S-3
G3	GRIDDLE 3 BURNERS	COOKRITE	ATMF-36
S1	36" S.S. GRAB BAR	BOBRICK	B-5806
S2	42" S.S. GRAB BAR	BOBRICK	B-5806
S3	TOILET PAPER DISPENSER	BOBRICK	B-2888
S4	SOAP DISPENSER	BOBRICK	B-2111
S5	PAPER TOWEL DISPENSER	BOBRICK	B-4262
S6	ADA MIRROR	BOBRICK	B-290
SS1	COMMERCIAL HX		SEE SHOP DRAWINGS
SS2	WORK TABLE 24X48	JOHN BOSS & CO	
SS3	WORK TABLE 24X36	JOHN BOSS & CO	
SS4	EQUIPMENT STAND	ADVANCE TACO	EG-LG-242-X

<p>DOOR SCHEDULE NOTES:</p> <ol style="list-style-type: none"> 1. DO NOT UNDERCUT DOORS. 2. PROVIDE A.D.A. COMPLIANT THRESHOLD W/ SOUND SWEEPS AT PRIVACY LOCATIONS. 3. CONTRACTOR SHALL PROVIDE AND INSTALL CUSTOMARY ACCESSORIES (SILENCERS, DOOR STOPS, ETC.) 	
<p>HARDWARE NOTES (DOORS & STOREFRONTS):</p> <ol style="list-style-type: none"> 1. ALL HARDWARE & THRESHOLDS TO COMPLY WITH CURRENT FLORIDA ACCESSIBILITY CODE. 2. ALL INTERIOR DOOR HARDWARE PACKAGES TO BE PER TENANT/LANDLORD AGREEMENT. (U.O.N.) 3. ALL EXTERIOR DOORS ARE EXISTING TO REMAIN. LOCKSETS TO BE RE-QUEP BY TENANT. 4. CONTRACTOR SHALL PROVIDE AND INSTALL CUSTOMARY ACCESSORIES (SILENCERS, DOOR STOPS, ETC.) FOR ALL DOORS WITH FINISHES AND STYLES PER TENANT/LANDLORD AGREEMENT. 	

SEE FINISH SCHEDULE
FOR INTERIOR WALL
FINISH

#5 12 SCREW @
EACH ANCHOR
VERIFY W/F RAME

3 5/8" 20 GA. GALV. METAL
STUD @ 16" O.C. AND 2 AT
DOOR FRAME

SEE FINISH SCHEDULE
FOR INTERIOR WALL
FINISH

CAULK FULL PERIMETER
BOTH SIDES

3 ANCHORS PER JAMB MIN.
ONE 12" FROM TOP AND
BOTTOM AND ONE @ CENTER
OF FRAME (30" O.C.C.)

SCALE: 3" = 1'-0"

5

DOOR

J-MOLDING

2"

#5 12 SCREW @ EACH ANCHOR VERIFY W/FRAME

SEE FINISH SCHEDULE FOR INTERIOR WALL FINISH

3 5/8" 20 GA. GALV. METAL STUD @ 16" O.C. AND 2 AT DOOR FRAME

SEE FINISH SCHEDULE FOR INTERIOR WALL FINISH

CAULK FULL PERIMETER BOTH SIDES



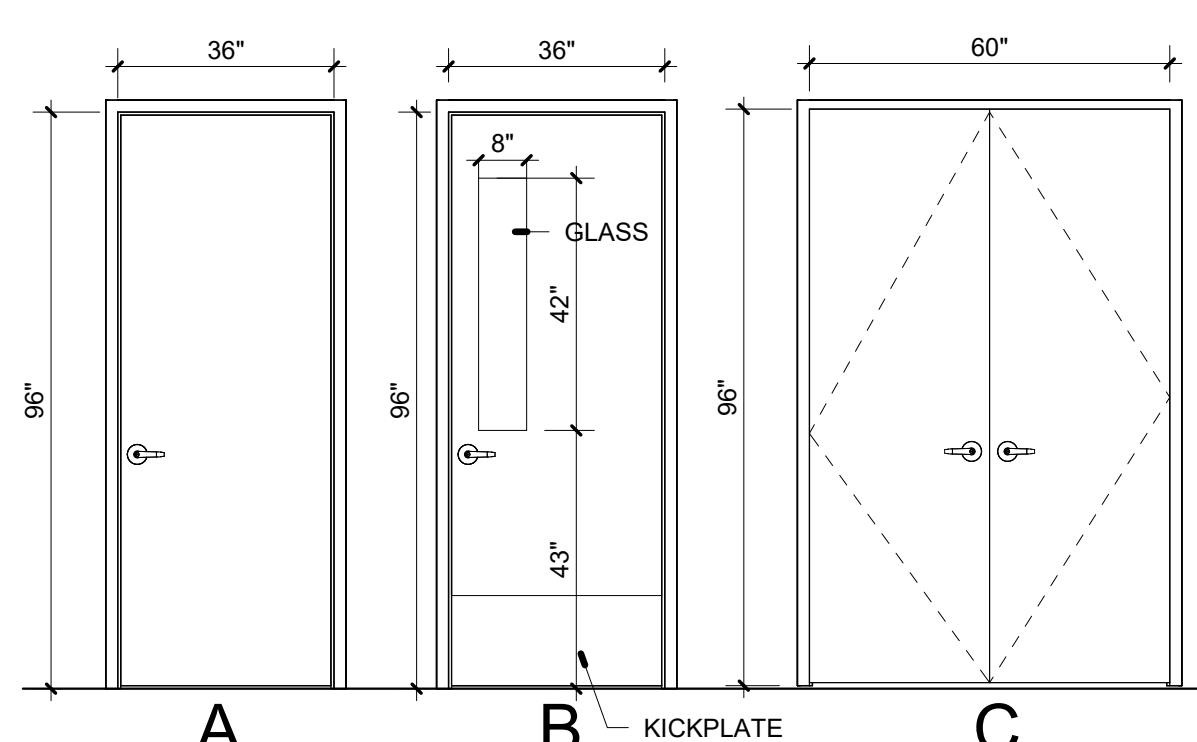

3 ANCHORS PER JAMB MIN. ONE 12" FROM TOP AND BOTTOM AND ONE @ CENTER OF FRAME (30" O.C.C.)

TYP. DOOR JAMB DETAIL PARTITION

SCALE: 3" = 1'-0"

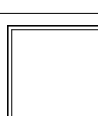

CEILING SCHEDULE			
TYPE MARK	TYPE	MANUFACTURER	DESCRIPTION
ACT	2' x 2' ACT System	ARMSTRONG	ACOUSTIC CEILING TILE. ANTIBACTERIAL - KITCHEN ZONE OR APPROVED EQUAL
GWB	GWB ON MTL. STUD		PAINTED DRYWALL
GWMR	GWMR ON MTL. STUD		EPOXY PAINTED DRYWALL

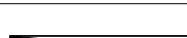
REFLECTED CEILING PLAN LEGEND	
SYMBOL	DESCRIPTION
	EXIT SIGN
	ALARM STROBE (CEILING MOUNTED)
	LED RECESSED LIGHT
	LED TROFFER LIGHT
	LED TROFFER LIGHT W/ EMERGENCY BATTERY PACK
	4" LED LINEAR LIGHT
	4" LED LINEAR LIGHT W/ EMERGENCY POWER SOURCE

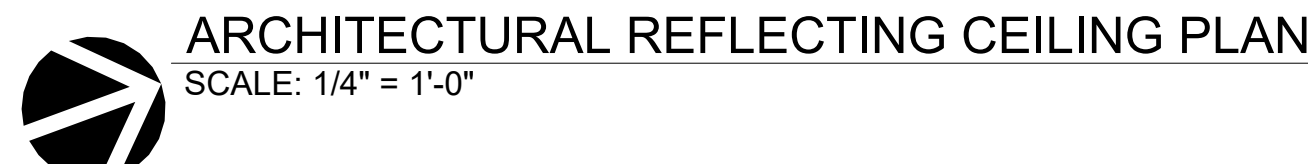
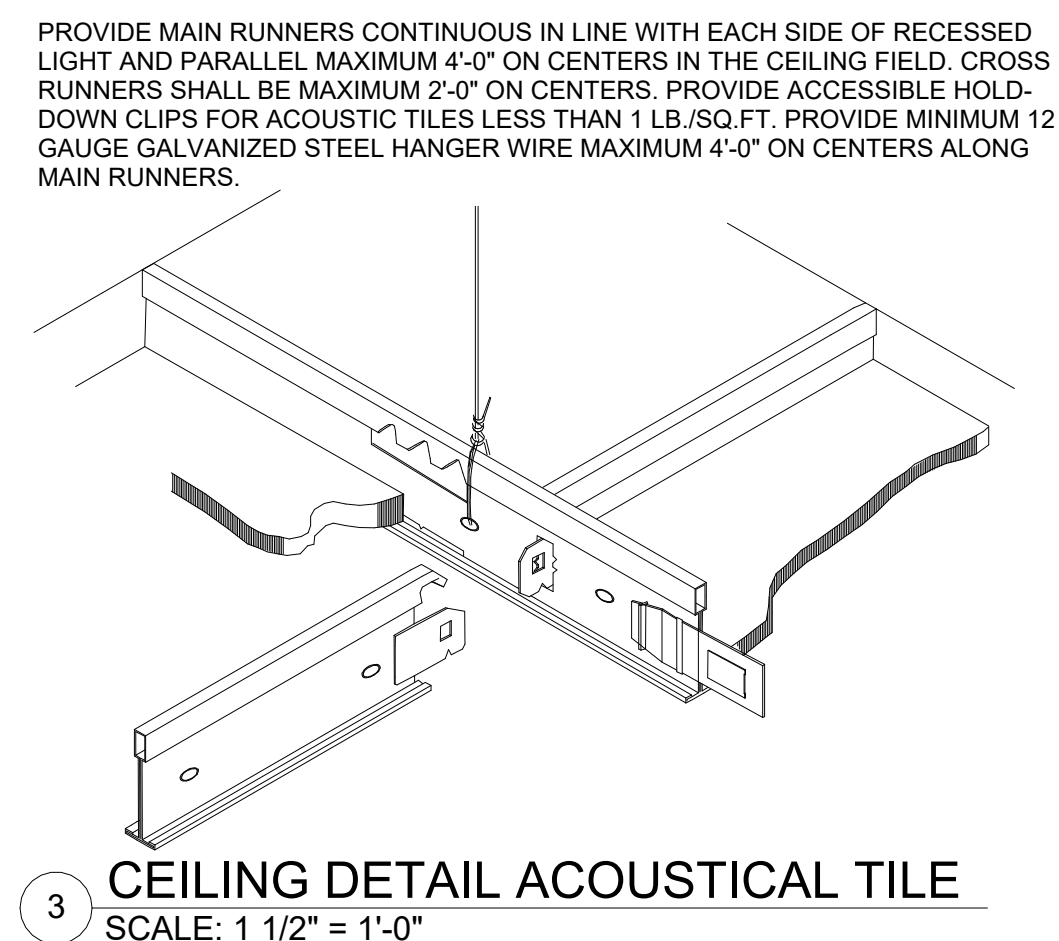

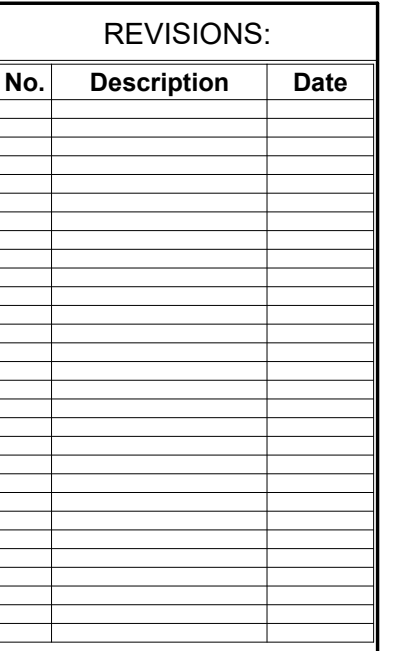

A200

