

Project No. 230-83.00	Sheet
Date AS NOTED	E-0.1
Scale AS NOTED	

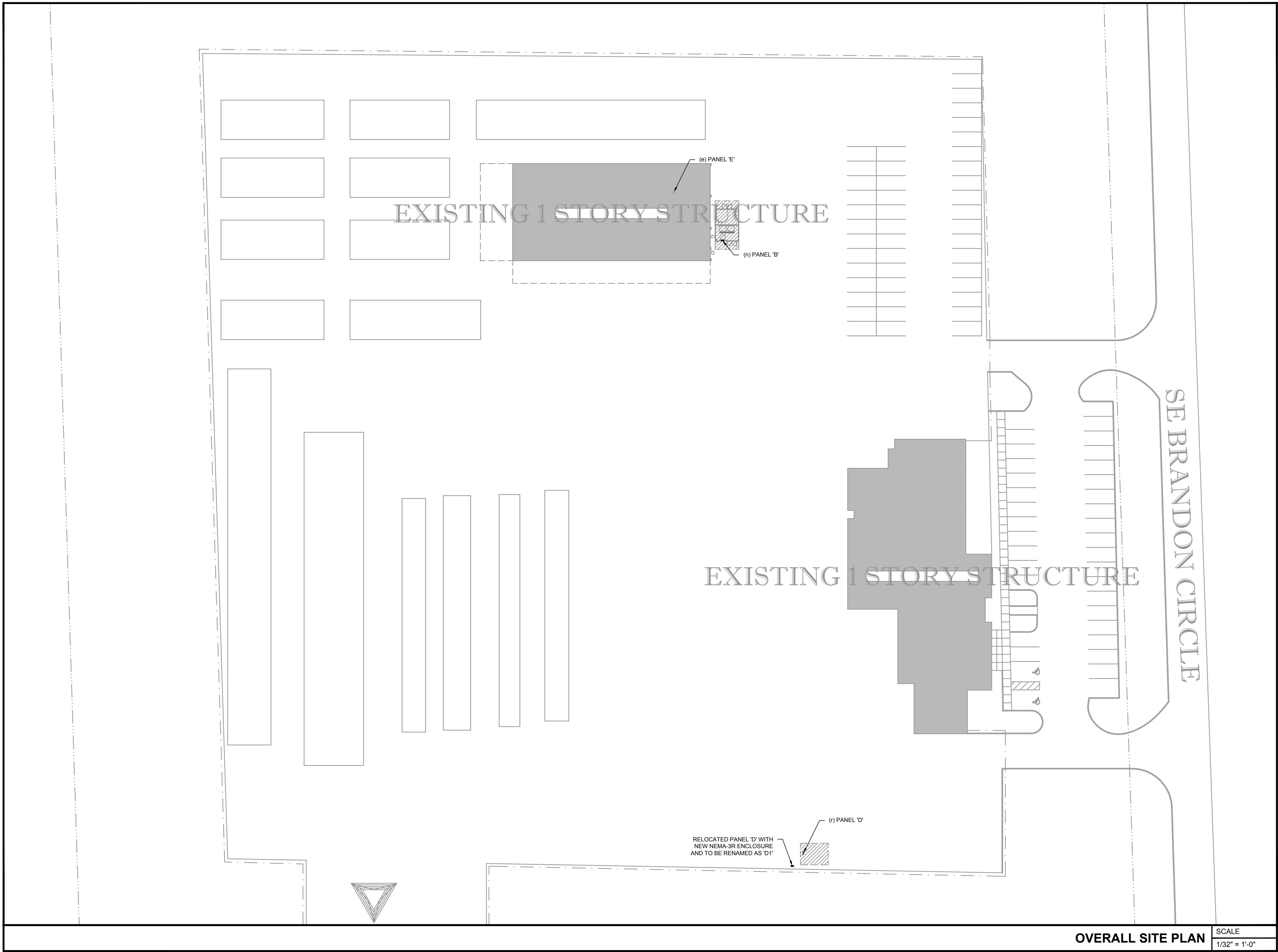

DEMOLITION NOTES:

- COORDINATION: DRAWINGS ARE TO BE USED ONLY AS A GUIDELINE FOR DEMOLITION. COORDINATE ALL DEMOLITION WORK WITH OTHER TRADES, WITH NEW WORK INDICATED ON CONSTRUCTION PLANS, AND WITH ACTUAL FIELD CONDITIONS.
- LOCKOUT/TAGOUT: VERIFY ALL SOURCES OF ELECTRICAL POWER TO AREA OF WORK ARE DISCONNECTED AND LOCKOUT/TAGOUT PROCEDURES ARE FOLLOWED PER OSHA REQUIREMENTS.
- NOT IN CONTRACT AREAS: LOCATE, IDENTIFY, AND PROTECT ELECTRICAL SERVICES (E.G. POWER, LIGHTING, CONTROL, COMMUNICATION, SECURITY, SIGNAL, LIFE SAFETY, AND FIRE ALARM) PASSING THROUGH DEMOLITION AREA AND SERVING OTHER AREAS OUTSIDE THE RENOVATION LIMITS. MAINTAIN SERVICES TO AREAS OUTSIDE DEMOLITION LIMITS. WHEN SERVICES MUST BE INTERRUPTED, INSTALL TEMPORARY SERVICE FOR AFFECTED AREAS.
- CONTINUITY OF SERVICE: ANY CIRCUITS FEEDING THROUGH DEVICES OR EQUIPMENT BEING REMOVED, RELOCATED, REWORKED, OR ABANDONED AND SERVING OTHER ELECTRICAL DEVICES, AND/OR EQUIPMENT SHALL BE MAINTAINED BY REWORKING EXISTING WIRING TO RESTORE CONTINUITY OF THE INTERRUPTED CIRCUITS.
- LIFE SAFETY: EXISTING EMERGENCY LIGHTING, EGRESS LIGHTING, AND FIRE ALARM SYSTEM AND NOTIFICATION APPLIANCES SHALL BE SALVAGED, MAINTAINED IN PROPER OPERATION, AND RECONFIGURED AS REQUIRED TO COMPLY WITH APPLICABLE CODES AND STANDARDS FOR EACH PHASE OF CONSTRUCTION.
- CODE VIOLATIONS: NOTIFY ENGINEER UPON DISCOVERY OF ANY EXISTING CODE VIOLATIONS FOR CORRECTIVE ACTIONS.
- EXISTING CIRCUITRY: THE CONTRACTOR MAY REUSE EXISTING CIRCUITRY AS FIELD CONDITIONS PERMIT AND WHERE DESIGN INTENT CAN BE MET. EC SHALL VERIFY THAT TOTAL NEW LOAD DOES NOT EXCEED 80% OF THE BREAKER CONTINUOUS CURRENT RATING.
- COMPLETE REMOVAL: ELECTRICAL EQUIPMENT AND DEVICES SHALL BE REMOVED COMPLETE INCLUDING CONDUIT, WIRE, HANGERS, AND SUPPORTS BACK TO SOURCE.
- PROTECTION BARRIERS: PROTECT ADJACENT MATERIALS INDICATED TO REMAIN. INSTALL AND MAINTAIN DUST AND NOISE BARRIERS TO KEEP DIRT, DUST, AND NOISE FROM BEING TRANSMITTED TO ADJACENT AREAS. REMOVE PROTECTION AND BARRIERS AFTER DEMOLITION IS COMPLETE.
- SALVAGE FOR REUSE: EXISTING EQUIPMENT NOTED TO REMAIN OR BE RELOCATED SHALL BE SALVAGED, REPAIRED, AND CLEANED FOR FUTURE USE. REPLACE MISSING HARDWARE OR DAMAGED EQUIPMENT AS REQUIRED.
- STORAGE: CONTRACTOR SHALL BE RESPONSIBLE FOR REMOVAL, PRESERVATION, STORAGE, AND PROTECTION OF ALL EQUIPMENT AND DEVICES DESIGNATED TO BE REMOVED AND REINSTALLED. EQUIPMENT SHALL BE STORED IN A MANNER TO AVOID DAMAGE UNTIL REINSTALLED.
- OWNER RETENTION: THE CONTRACTOR SHALL REMOVE ALL EQUIPMENT NOT INDICATED TO BE REUSED TO A DESIGNATED LOCATION AT THE PROJECT SITE. AFTER THE EQUIPMENT HAS BEEN ASSEMBLED FOR THE OWNER'S INSPECTION AND POSSIBLE RETENTION, ALL EQUIPMENT NOT TO BE RETAINED BY THE OWNER SHALL BE REMOVED FROM THE SITE BY THE CONTRACTOR.
- PANELBOARD CIRCUIT DIRECTORY: ALL PANELBOARDS SHALL BE FURNISHED WITH REVISED TYPEWRITTEN CIRCUIT DIRECTORY CARDS WITH THE EQUIPMENT AND SPACE SERVED PROPERLY DESIGNATED. EXISTING EQUIPMENT SHALL BE RE-IDENTIFIED AS REQUIRED TO COORDINATE WITH PROPOSED DESIGN.
- SPARED OUT CIRCUITS: BRANCH CIRCUIT BREAKERS MADE SPARE AS A RESULT OF DEMOLITION ACTIVITIES SHALL BE SWITCHED TO THE 'OFF' POSITION AND LABELED AS "SPARE".
- RAISED CEILINGS: WHERE ARCHITECTURAL CEILINGS ARE TO BE RAISED, THE EC SHALL REWORK EXISTING OVERHEAD CONDUIT AND CONDUCTORS, IF ANY, TO ALLOW FOR THE CEILING TO BE RAISED.
- HARD CEILINGS: WHERE NEW HARD CEILING IS TO BE INSTALLED, EC SHALL REWORK AND RELOCATE ALL JUNCTION BOXES OUT FROM ABOVE NEW HARD CEILING. NEW JUNCTION BOX LOCATIONS SHALL BE IN AN ACCESSIBLE AREA ABOVE CEILING.

DEMOLITION LEGEND:

- DISCONNECT AND REMOVE/RELOCATE EXISTING DEVICES, FIXTURES, AND EQUIPMENT TO ACCOMMODATE THE PROPOSED DESIGN INTENT. REFER TO THE FULL SET OF DEMOLITION AND PROPOSED PLANS FROM ALL TRADES FOR ADDITIONAL NOTES AND REQUIREMENTS.
- (d) SUBSCRIPT DENOTES EXISTING TO BE REMOVED. DISCONNECT AND REMOVE WIRE AND CONDUIT BACK TO SOURCE. MAINTAIN SERVICE TO REMAINING DEVICES.
 - (e) SUBSCRIPT DENOTES EXISTING TO REMAIN. MAINTAIN SERVICE VIA EXISTING CIRCUIT.
 - (r) SUBSCRIPT DENOTES EXISTING TO BE RELOCATED. MATCH EXISTING WIRING AND CONDUIT AND EXTEND TO PROPOSED LOCATION.
 - (er) SUBSCRIPT DENOTES EXISTING DEVICE/FIXTURE TO BE REPLACED IN SAME LOCATION AS EXISTING. DISCONNECT AND REMOVE EXISTING DEVICE/FIXTURE AND MAINTAIN SERVICE VIA EXISTING CIRCUIT.
- DASHED LINES INDICATE EXISTING TO BE REMOVED, EXISTING TO BE RELOCATED, OR EXISTING TO BE REPLACED.
- LIGHT LINES INDICATE EXISTING TO REMAIN.
- GRAY SHADED AREAS INDICATE "NOT IN CONTRACT (N.I.C.," AREAS. MAINTAIN CONTINUITY OF EXISTING SERVICES.



Date		Revision/Issue	
02/07/2024	07/28/2023	ISSUE FOR PERMIT	ISSUE FOR CLIENT REVIEW
2	1	No	No

INFINITY
INFINITY ENGINEERING GROUP, LLC
1208 East Kennedy Boulevard
Suite 230
Tampa, Florida 33602
[p]: 813.434.4770
[f]: 813.445.4211
www.ieggroup.net
FL Cert. of Auth. No. 27889



ANDREW MOHR, P.E.
FL REG. NO. 73077

Date
This item has been electronically signed and sealed by (Licensee, PE) on the date and/or time stamp shown using a digital signature. Printed copies of this document are not considered signed and sealed and the signature must be verified by a 3rd Party Certificate Authority on any electronic copy.
FAC 61G15-23.004

Project Name and Address
FPL - WALTON ICE MACHINE
1050 SE BRANDON COURT, PORT ST. LUCIE, FL 34952

Sheet Title
ELECTRICAL OVERALL SITE PLAN

Project No. 230-83.00	Sheet
Date AS NOTED	E-1.0
Scale AS NOTED	

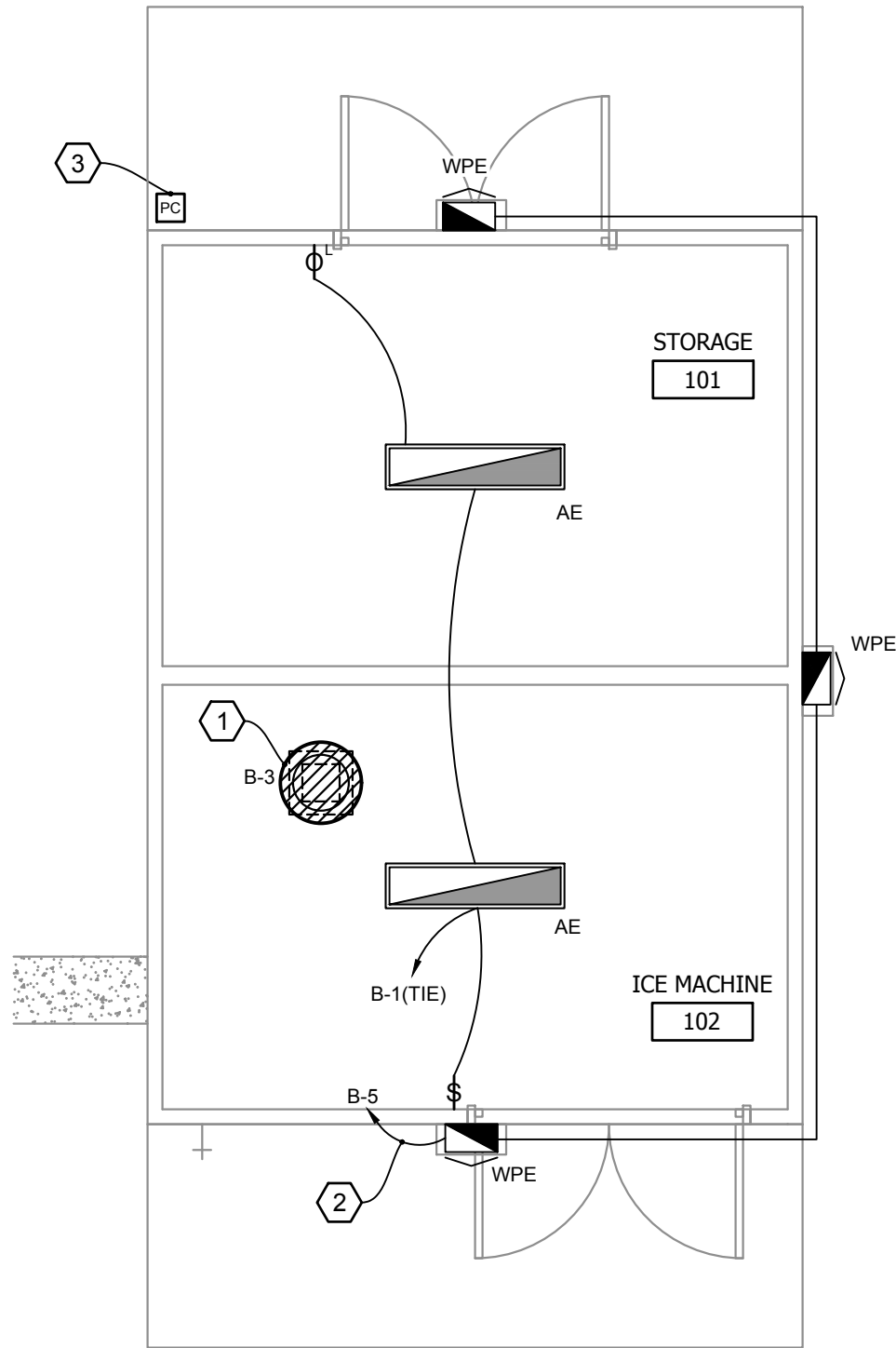

ELECTRICAL PROPOSED LIGHTING PLAN

SCALE
1/4" = 1'-0"

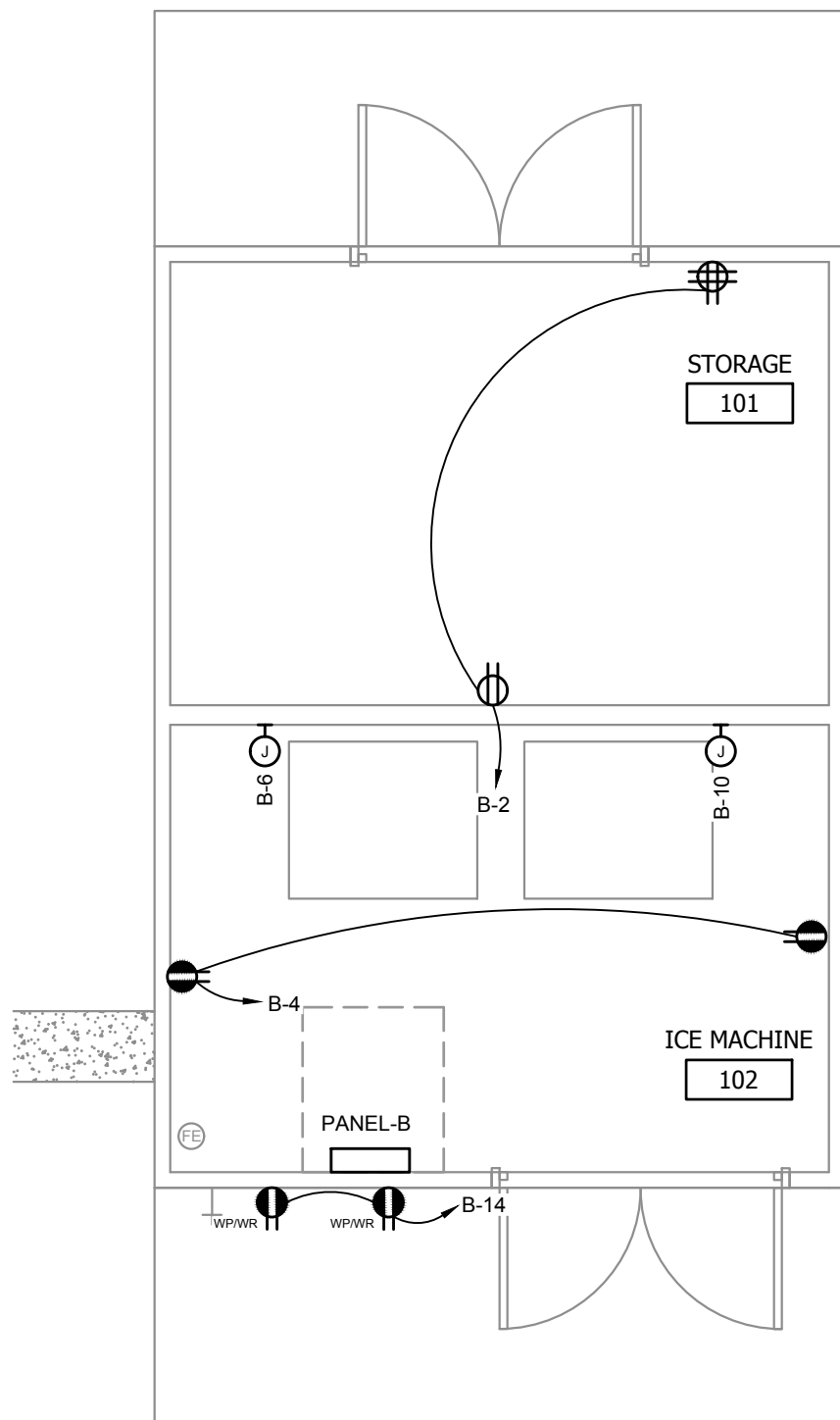

ELECTRICAL PROPOSED FLOOR PLAN

SCALE
1/4" = 1'-0"

NEW WORK LEGEND:

REFER TO THE FULL SET OF PROPOSED PLANS FROM ALL TRADES FOR ADDITIONAL NOTES AND REQUIREMENTS. ALL DEVICES, FIXTURES, AND EQUIPMENT SHOWN ON THE PROPOSED ELECTRICAL PLANS ARE NEW UNLESS NOTED OTHERWISE WITH THE BELOW DESIGNATIONS.

- (e) SUBSCRIPT DENOTES EXISTING TO REMAIN. MAINTAIN SERVICE VIA EXISTING CIRCUIT.
- (n) SUBSCRIPT DENOTES NEW.
- (r) SUBSCRIPT DENOTES EXISTING TO BE RELOCATED. MATCH EXISTING WIRING AND CONDUIT AND EXTEND TO PROPOSED LOCATION. WIRING DEVICES SHALL BE PROVIDED WITH NEW DEVICES AND COVER PLATES TO MATCH NEW WORK. LIGHT FIXTURES SHALL BE CLEANED AND RE-LAMPED.
- (er) SUBSCRIPT DENOTES EXISTING DEVICE/FIXTURE TO BE REPLACED IN SAME LOCATION AS EXISTING. RECONNECT NEW DEVICE/FIXTURE TO EXISTING CIRCUIT. WIRING DEVICES SHALL BE REPLACED WITH NEW DEVICES AND COVER PLATES TO MATCH NEW WORK. LIGHT FIXTURES SHALL BE REPLACED WITH NEW FIXTURES PER LIGHTING FIXTURE SCHEDULE.
- DARK LINES INDICATE NEW, EXISTING TO BE RELOCATED, OR EXISTING TO BE REPLACED.
- LIGHT LINES INDICATE EXISTING TO REMAIN.
- GRAY SHADED AREAS INDICATE "NOT IN CONTRACT (N.I.C.)" AREAS. MAINTAIN CONTINUITY OF EXISTING SERVICES.

SHEET NOTES:

- HALF SHADED OR FULLY SHADED LUMINAIRES SHALL BE PROVIDED WITH SELF-CONTAINED 90-MINUTE BACK-UP BATTERY PACKS.
- EMERGENCY LIGHTING FIXTURES SHALL SWITCH WITH LOCAL NORMAL LIGHTING UNLESS INDICATED AS "EM/NL" OR "NL" (NIGHT LIGHT).
- EMERGENCY FIXTURES WITH INTEGRAL 90-MINUTE BATTERY PACKS SHALL BE PROVIDED WITH AN UN-SWITCHED HOT CONDUCTOR SO THAT EMERGENCY BATTERY PACK CAN CHARGE WHEN POWER TO THE LIGHT FIXTURES IS SWITCHED OFF.
- EXIT AND NIGHT LIGHT FIXTURES SHALL BE CONNECTED TO UN-SWITCHED CIRCUIT AHEAD OF LIGHTING CONTROLLER.
- THE CIRCUIT NEUTRAL CONDUCTOR SHALL BE ROUTED TO EACH LINE VOLTAGE WALL SWITCH. WHERE THE WIRING DEVICE DOES NOT REQUIRE THE USE OF A NEUTRAL CONDUCTOR, CAP FOR FUTURE USE.

KEYED NOTES:

- ROOF MOUNTED EXHAUST FAN: PROVIDE NEW ROOF MOUNTED EXHAUST FAN TIED TO WALL MOUNTED REVERSE-ACTING THERMOSTAT. COORDINATE ALL WORK WITH MECHANICAL CONTRACTOR.
- WALL PACK: INSTALL WALLPACK AND CONNECT TO EXTERIOR LIGHTING CIRCUIT VIA PHOTOCELL.
- PHOTOCELL: PROVIDE PHOTOCELL AND LOCATE THE PHOTOCELL UNDER EVE.

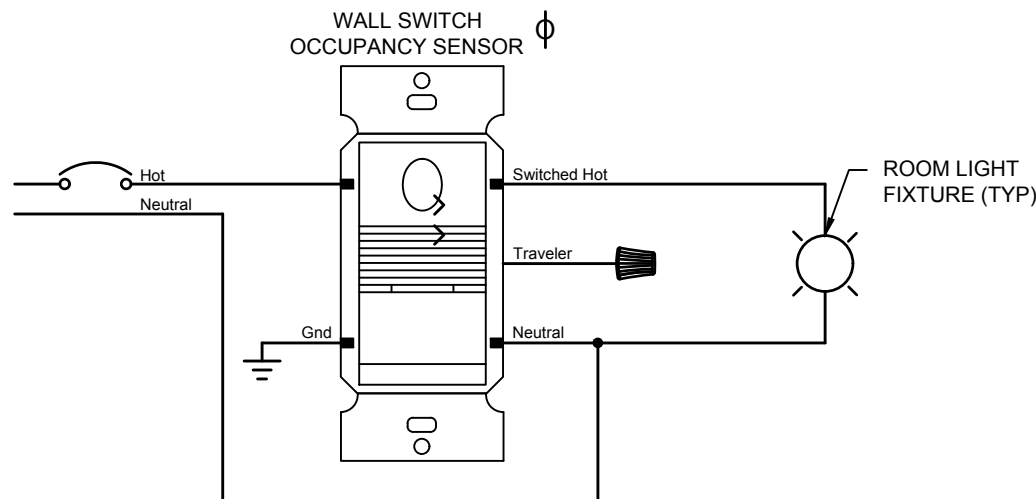

- NOTES:
- THE CIRCUIT NEUTRAL CONDUCTOR SHALL BE ROUTED TO EACH LINE VOLTAGE OCCUPANCY SENSOR.

LINE VOLTAGE OCCUPANCY SENSOR
WIRING DIAGRAM

SCALE
N.T.S.

2

LIGHTING FIXTURE SCHEDULE

LABEL	DESCRIPTION	LIGHT FIXTURE		MOUNTING	TYPE OF LAMPS	VOLTS	WATTS
		MFG.	MODEL NUMBER				
AE	LED STRIP LIGHT, UL DAMP LOCATION LISTED WITH EMERGENCY BATTERY BACK UP	LITHONIA	ZL1N-L48-5000LM-FST-MVOLT-40K-80CRI-WH E7W	SUSPENDED	LED	120	34
WPE	VOLTAIRE MINI ARCHITECTURAL WALL PACK WITH INTEGRAL EMERGENCY BATTERY BACKUP	H.E WILLIAMS	VWPV-L30-740-T3-SDGL-DIM-UNV-EM/4W-HSGX	WALL MOUNTED	LED	121	25

- NOTE:
- PROVIDE NECESSARY MOUNTING HARDWARE AND ACCESSORIES FOR ALL FIXTURES.
 - CONFIRM SELECTION OF ALL LIGHT FIXTURES WITH ARCHITECT/OWNER PRIOR TO ORDERING.

LIGHTING CONTROL SCHEDULE:

TYPE	DESCRIPTION	MANUFACTURER	CATALOG NUMBER	MOUNTING	RATINGS	NOTES
φ ¹	OCCUPANCY SENSOR - WALL SWITCH, PASSIVE INFRARED, ONE-BUTTON, ON/OFF, LINE VOLTAGE	ACUITY CONTROLS	WSX	WALL	@120V, 800W, 1/4HP @277V, 1200W, 1/4HP MAJOR MOTION: 36' RADIAL MINOR MOTION: 20' RADIAL	

- GENERAL NOTES:
- REFER TO ELECTRICAL SPECIFICATIONS FOR ADDITIONAL REQUIREMENTS WHICH MAY NOT NECESSARILY BE REFLECTED IN CATALOG NUMBER AND/OR DESCRIPTION IN THE SCHEDULE.
 - PROVIDE ALL LIGHTING CONTROL COMPONENTS TO PERFORM FUNCTION AS DESCRIBED ON THESE PLANS. PROVIDE ALL BRIDGES, GATEWAYS, POWER SUPPLIES, POWER PACKS / ROOM CONTROLLERS, ACCESSORIES, AND PROGRAMMING FOR A COMPLETE AND FULLY FUNCTIONAL LIGHTING CONTROL SYSTEM. LIGHTING CONTROLS ARE INDICATED FOR DESIGN INTENT ONLY. EC SHALL PROVIDE SHOP DRAWINGS AND PRODUCT CUTSHEETS FOR REVIEW BY THE ENGINEER. PROVIDE DETAILED DESCRIPTIONS OF LIGHTING FUNCTIONS FOR EACH ROOM.
 - PROVIDE ALL PROGRAMMING, COMMISSIONING, AND TRAINING OF LIGHTING CONTROLS AS REQUIRED BY THESE PLANS, OWNER AND LANDLORD REQUIREMENTS, AND ENERGY CODE.
 - LIGHTING CONTROL SYSTEM FUNCTIONAL TESTING SHALL BE PROVIDED AND DOCUMENTS CERTIFYING THAT THE INSTALLED LIGHTING CONTROLS MEET THE PERFORMANCE CRITERIA OF THE PLANS AND SPECIFICATIONS SHALL BE PROVIDED TO THE OWNER AND ENGINEER WITHIN 90 DAYS FROM THE DATE OF RECEIPT OF THE CERTIFICATE OF OCCUPANCY.
 - POWER PACKS / ROOM CONTROLLERS ARE INDICATED ON PLANS AS SINGLE RELAY UNITS FOR CLARITY ONLY. MULTI-RELAY POWER PACKS / ROOM CONTROLLERS MAY BE USED IN LIEU OF SINGLE RELAY UNITS. COORDINATE WITH MANUFACTURER FOR SELECTIONS.

- NOTES:
- SELECT APPROPRIATE NUMBER OF CONTACTS BASED ON APPLICATION.
 - FOR DUAL AND TRIPLE CONTACT APPLICATION, CONNECT SINGLE POLE PACKS TOGETHER VIA CAT 5 BUS.



INFINITY ENGINEERING
GROUP, LLC

1208 East Kennedy Boulevard
Suite 230
Tampa, Florida 33602
[p]: 813.434.4770
[t]: 813.445.4211
www.iegroun.net
FL Cert. of Auth. No. 27889



ANDREW MOHR, P.E.
FL REG. NO. 73077

Date
This item has been electronically signed and sealed by (Licensee, PE) on the date and/or time stamp shown using a digital signature. Printed copies of this document are not considered signed and sealed and the signature must be verified by a 3rd Party Certificate Authority on any electronic copy.
FAC 61G15-23.004

Project Name and Address
FPL - WALTON ICE MACHINE
1050 SE BRANDON COURT, PORT ST. LUCIE, FL 34952

Sheet Title
ELECTRICAL PROPOSED
FLOOR AND CEILING PLAN

Project No.
230-83.00
Date
AS NOTED
Scale
AS NOTED

Sheet
E-2.0

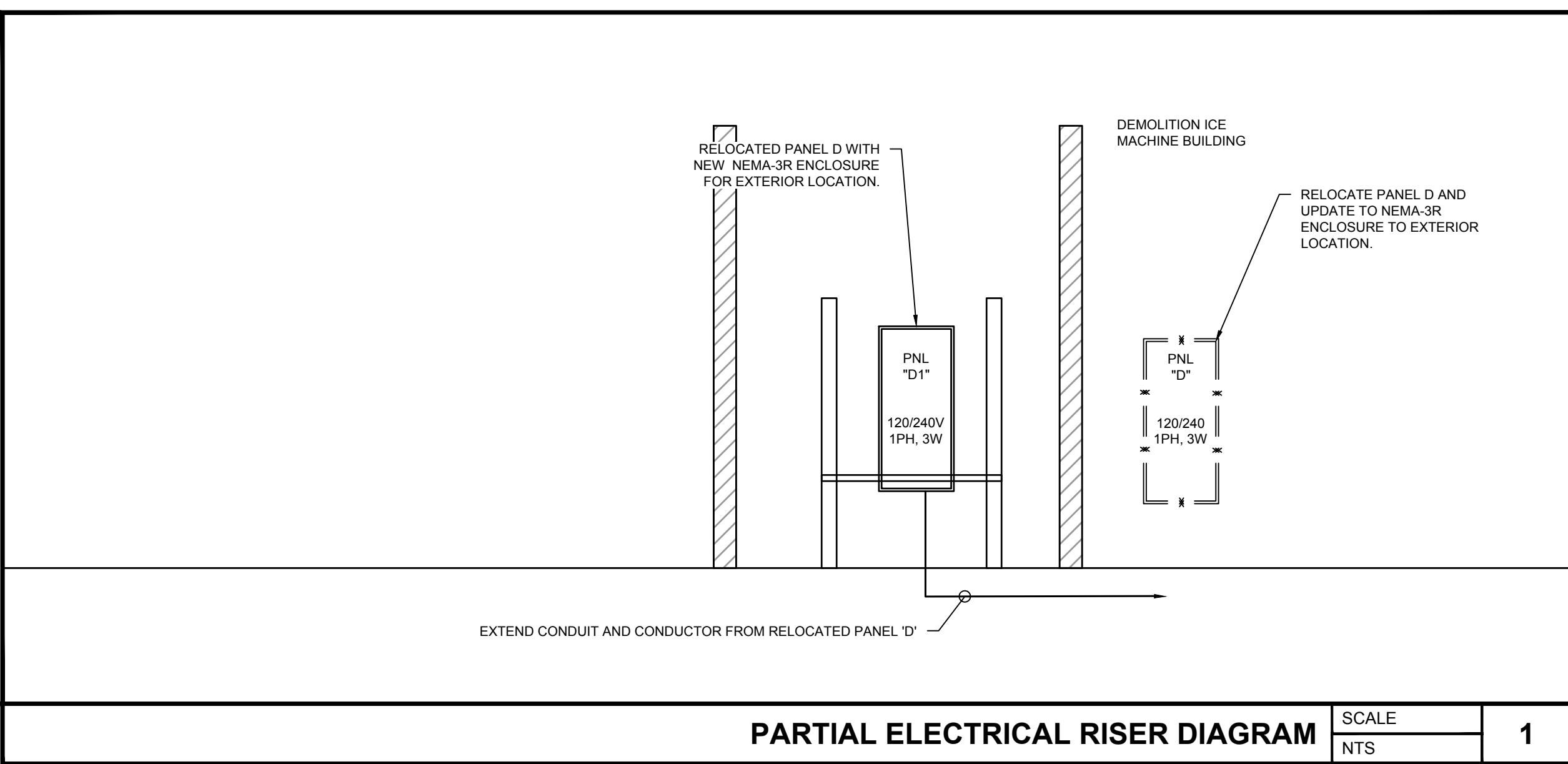
[illegible]

1. PROVIDE PANELBOARD AS SPECIFIED ON ELECTRICAL PANEL SCHEDULES AND RISER DIAGRAM.
2. CONTRACTOR SHALL ENSURE ALL NEC WORKING SPACE AND DEDICATED EQUIPMENT SPACE CLEARANCES ARE PROVIDED PER NEC 110. IF FIELD CONDITIONS DO NOT ALLOW FOR ADEQUATE CLEARANCE AT THE LOCATION SHOWN ON THE PLANS, THE CONTRACTOR SHALL PROPOSE AN ALTERNATE LOCATION FOR REVIEW AND APPROVAL BY ENGINEER PRIOR TO ROUGH-IN OF PANEL.
3. FIELD COORDINATE INSTALLATION WITH OTHER TRADES TO ENSURE NO FOREIGN SYSTEMS ARE LOCATED WITHIN THE DEDICATED EQUIPMENT SPACE OF THE ELECTRICAL EQUIPMENT.
4. ALL BUSING SHALL BE COPPER.
5. BOLT-ON BREAKERS ONLY.
6. PROVIDE DOOR-IN-DOOR TRIM.
7. PROVIDE TYPEWRITTEN CIRCUIT DIRECTORY CARD.
8. ALL PANEL PARTS SHALL BE SUPPLIED FROM THE SAME MANUFACTURER.
9. IN EXISTING INSTALLATIONS, NEW CIRCUIT BREAKERS SHALL MATCH EXISTING IN TYPE AND AIC RATING, UNO.
10. LOAD TYPES IN DESCRIPTION AS FOLLOWS:

BOLD TEXT	NEW LOAD, WIRE, CONDUIT, CIRCUIT BREAKER (AS APPLICABLE)
GRAY TEXT	EXISTING LOAD, WIRE, CONDUIT, CIRCUIT BREAKER (AS APPLICABLE) TO REMAIN
(OLD X-#)	RELOCATED CIRCUIT FROM OLD PANEL 'X'; CIRCUIT '#'
CLG	COOLING
EWI	ELECTRIC WATER HEATER
HTG	HEATING
KIT	KITCHEN
LTG	LIGHTING
MISC	MISCELLANEOUS
MTR	MOTOR
REC	RECEPTACLE
REF	REFRIGERATION
SIGN	SIGNAGE
11. CIRCUIT BREAKER TYPE ABBREVIATIONS ARE AS FOLLOWS:

AFCI	ARC-FAULT CIRCUIT INTERRUPTER
F/RED	RED MARKING, L/ON HARDWARE, & "FIRE ALARM CIRCUIT"
GFCI	GROUND-FAULT CIRCUIT INTERRUPTER
GFPE	30 mA EQUIPMENT GROUND FAULT PROTECTION
HT2	HANDLE TIE FOR SHARED NEUTRAL CIRCUIT (2 POLE)
HT3	HANDLE TIE FOR SHARED NEUTRAL CIRCUIT (3 POLE)
L/ON	LOCKABLE "LOCK ON" HANDLE HARDWARE
L/OFF	LOCKABLE "LOCK OFF" HANDLE HARDWARE
TAN	TANDEM
SHNT	SHUNT TRIP
SPD	SURGE PROTECTION DEVICE CIRCUIT BREAKER UNIT
SWD	SWITCH DUTY RATED
SWN	SWITCHED NEUTRAL
12. CIRCUIT BREAKER FURNISHED AS FOLLOWS:

ETR	EXISTING TO REMAIN
FW	FACTORY WIRE
NEW	NEW TO MATCH EXISTING
REM	REMOVE EXISTING AND PROVIDE NEW
13. LOAD FUNCTION AS FOLLOWS:

CONT	CIRCUIT CONTROLLED BY CONTACTOR
HOOD	CIRCUIT CONTROLLED BY HOOD FIRE SUPPRESSION SYSTEM
T/C	CIRCUIT CONTROLLED BY TIME CLOCK
PHO	CIRCUIT CONTROLLED BY PHOTOCELL
LCP	CIRCUIT CONTROLLED BY LIGHTING CONTROL PANEL
L/C	CIRCUIT CONTROLLED BY LIGHTING CONTACTOR
14. ABBREVIATIONS:

SR	SEE RISER
----	-----------